

PLAN NO 1831
FOR THE IMPROVEMENT OF
LE ROY STREET

BETWEEN
TWENTY-NINTH STREET AND MARSHALL BOULEVARD
IN THE
CITY OF SAN BERNARDINO
CALIFORNIA

MARCH 1949

R.D. FOR
ACTING C

PLAN ADOPTED May 2, 1949

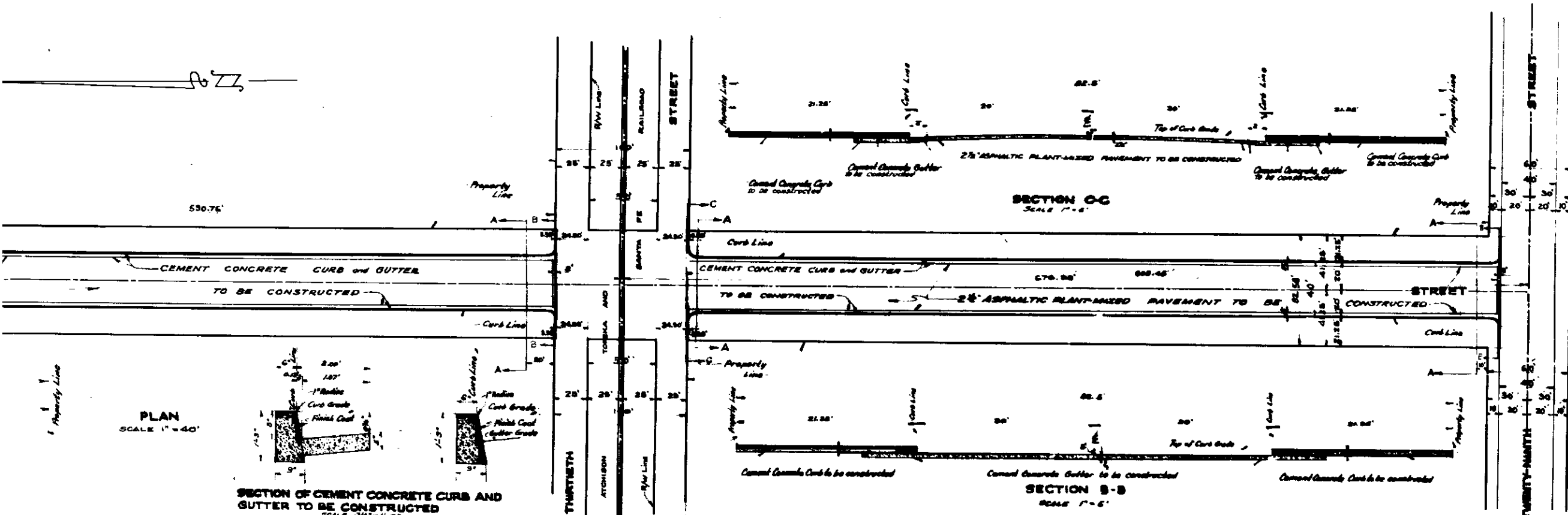

SECTION OF CEMENT CONCRETE CURB AND GUTTER TO BE CONSTRUCTED
SCALE 1"=1'-0"

EXPANSION JOINTS
A 1/2" Expansion Joint shall be constructed at intervals of 50 ft. Here all Concrete Curbs and Gutters ordered constructed on this plan.

PROFILE LEGEND
Approximate present surface of ground shown by Black Line
Grade to which work shall be done shown by Red Line
Top of Curb Grade to which work shall be done

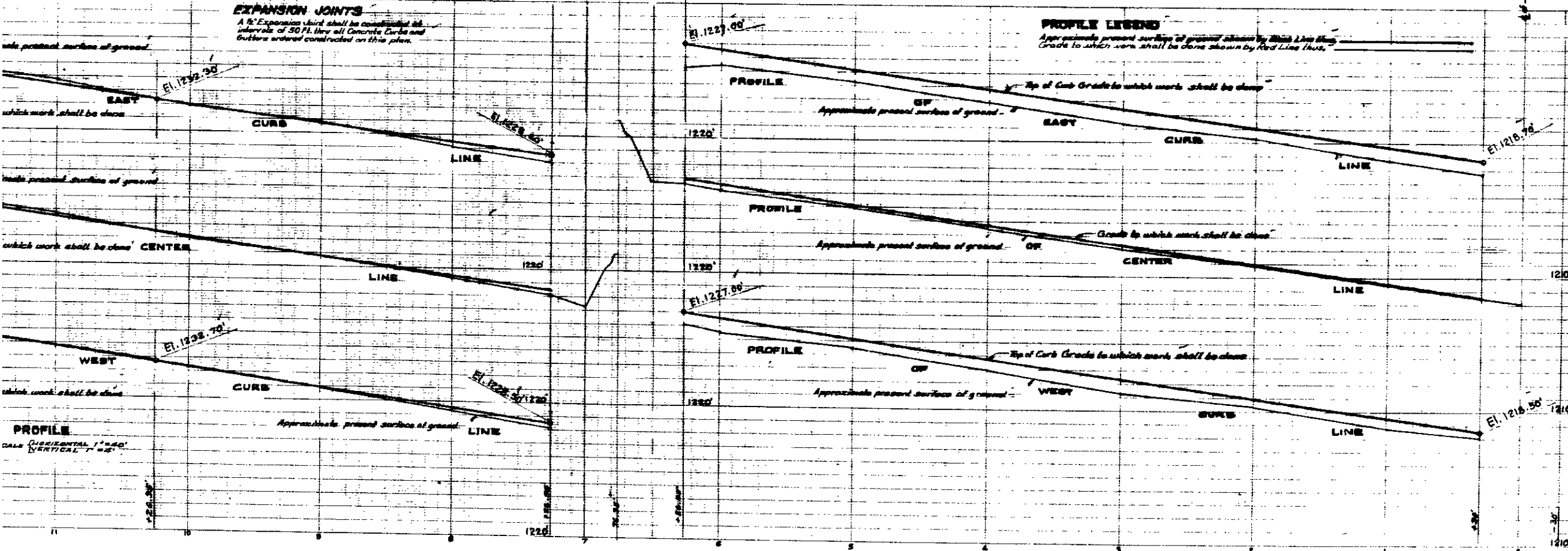

LEGEND
or it means with or without
or it means feet or feet
No means Number
El. means Elevation
L. means Center Line
Cement Concrete Curb to be constructed shown on plan that
Cement Concrete Gutter to be constructed shown on plan that
2 1/2" Asphaltic Plant-Mixed Pavement to be constructed shown on plan that

TITLE TO STREETS
LE ROY STREET was dedicated as Aliso Street by map of Arroyohead Tract, recorded in Book 11 of maps of page 27, records of San Bernardino County, California. Aliso Street was changed to LE ROY STREET by Resolution No 358 of the City of San Bernardino Adopted Feb. 8, 1936.

GRADE ORDINANCE
Grade of LE ROY STREET was established by Resolution No 1638 of the City of San Bernardino, California. Adopted Nov. 28, 1948. Width of Sidewalk and Curb Line established by Resolution No 1641 of the City of San Bernardino Adopted February 21, 1949.

DATUM
All Elevations shown in Red ink are in feet and are above a plane which is 1045.28 feet below the City Bench Mark as established by Ordinance 285 of the City of San Bernardino, California.